



**#21 – 11536 236 Street,  
Maple Ridge, B.C.**

**Totals\*\***

Main Level: 858 sq. ft.  
Upper Level: 763 sq. ft.  
Total: 1,621 sq. ft.

Garage: 207 sq. ft.

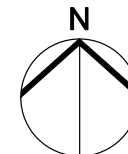
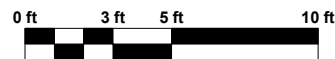
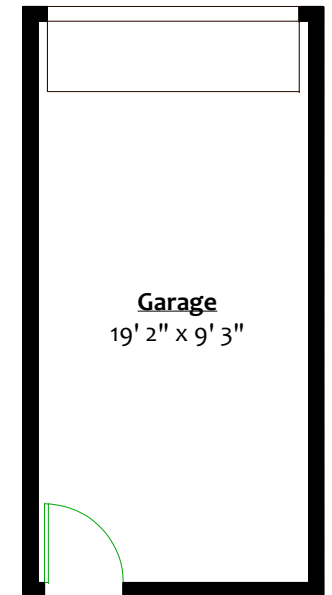
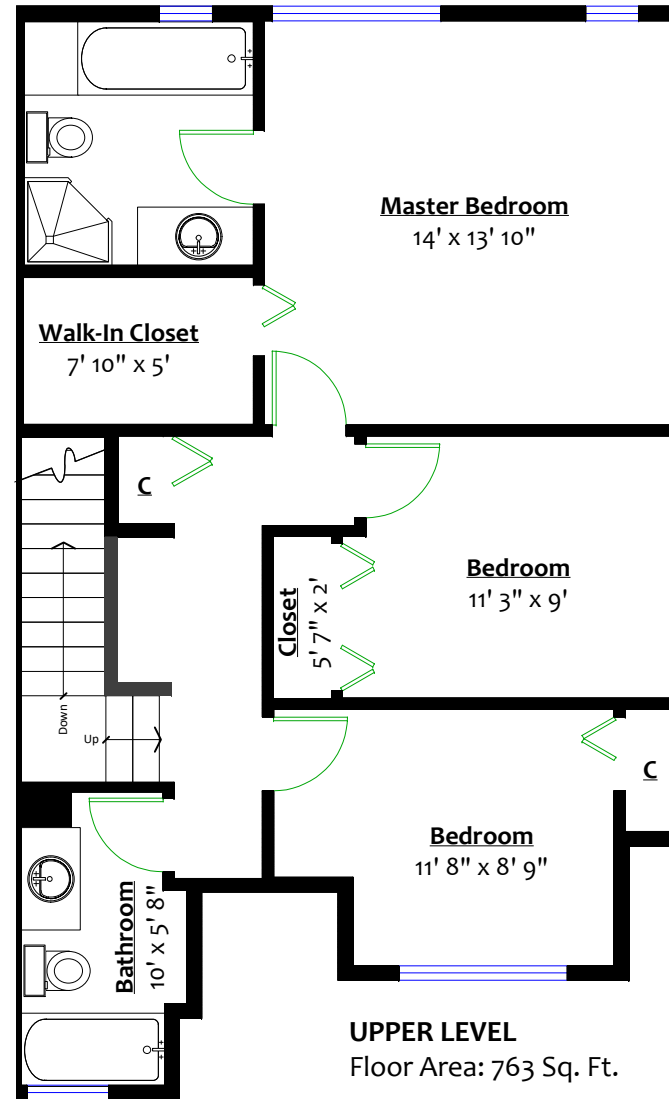
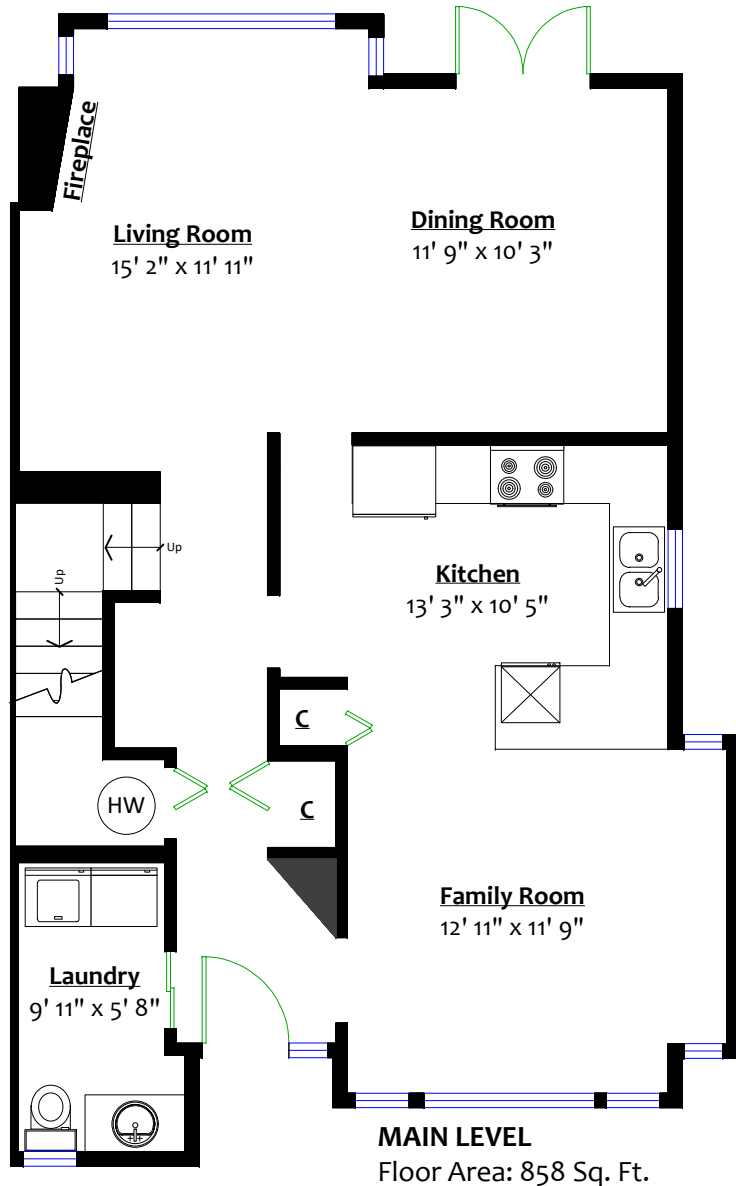

\*\* Approx. based on interior measurements to exterior walls  
\*\* Total square footage not taken from original blueprints